

ROYAL WHARF

LONDON



APARTMENT SERVICES QUICK STEP GUIDE **USER MANUAL**



Contents

1. FAQ.....	4
1.1. Operate your Heating	4
1.2. Apartments Lamps & Lights.....	5
1.3. Shower Unit.....	5
1.4. Home circulation Fan	6
1.5. Energy Monitor Device.....	7
1.6. Door Entry Phone	7
1.7. Towel Rail Timeguard.....	8
2. Operate your Heating.....	9
2.1. Room Heating Controller - Introduction	9
2.2. How to set your time and date	10
2.3. How to set your program	11
2.4. Programming summer - winter	15
2.5. How to change Comfort, Working and Economy modes.	16
2.6. How to temporarily change the temperature in your apartment.....	17
3. Apartments Lamps and Lights.....	18
3.1. Product Description	18
3.2. Light fixture components.....	18
3.3. How to change your lamp bulb	18
3.4. Lamp safety.....	22
4. Shower Unit	23
4.1. Operation	23
4.2. Cleaning Shower Head	25
5. Home Circulation Fan.....	27
5.1. Description and Fan Types.....	27
5.1. MEV Fan (Mechanical Extract)	28

5.2.	How MEV Fan works.....	28
5.3.	MVHR Fan (Mechanical Ventilation with Heat Recovery).	29
5.5.	How MVHR works	30
5.6.	Filter Maintenance.....	30
6.	Energy Monitor Device	31
6.1.	Insight	31
6.2.	Contents of Energy Monitor Device	31
6.3.	Powering Up & Setup Procedures.....	32
6.4.	Help Section.....	36
7.	Door Entry Phone.....	37
7.1.	User guide	37
8.	Towel Rail Timeguard.....	38
8.1.	Description	38
8.2.	Battery.....	39
8.3.	Setting the clock.....	39
8.4.	Modifying the Time & Date of Day.....	41
8.5.	Programming On/Off times.....	42
8.6.	Programming Across Midnight	44
8.7.	Modifying or Adding Programmes.....	44
8.8.	Boost	45

1.FAQ

1.1. Operate your Heating

What is a Thermostat and where is it located?

Thermostat (Chronothermostat) is a component, which is the main control unit for a heating system and hot water supply. Thermostat is located on the wall in your living room. You can choose from 4 different fixed programs and in case, there is no program suitable for you, you can set up your own weekly program of heating and hot water supply. If you want to learn more about your Thermostat and its setting, please go to [page number 9](#).

How can I set the Time & Date on thermostat?

Your Time and Date should be displayed on the Thermostat. Please, check the Thermostat display. If the screen doesn't show any information about Date and Time and Program (this can be caused by powering off), please, go to [page number 10](#) and set your Date, Time and Program.

How can I set my weekly Heating & Hot water program?

The Thermostat installed in your apartment has 4 fixed weekly programs of heating for each day of the week from Monday to Sunday. You can choose one of these programs. If you are not happy with any of these programs, please follow the [page number 11](#) and set up your own program. You also can increase and decrease the temperature in your apartment for a couple of hours only. For more information, please go to [page number 17](#).

My apartment is too hot/cold. How can I increase/decrease the temperature in my apartment?

If you set up your program, but suddenly you feel your apartment is too cold/too hot, you can change the temperature only for few hours without changes in the actual program. For more information, how to boost (increase/decrease) the temperature in your apartment, please go to [page number 17](#).

1.2. Apartments Lamps & Lights

Lights don't work. What should I do?

If all your lights don't work at all, please go to your Utility cupboard and check the Fuse box (CCU) and the positions of the switches inside of it. Position UP is on, position DOWN is off. All switches are labelled. If Lights switches are OFF (position DOWN), please turn them on (flick it to the UPPER position). Lights should work now.

If only one (few) lights are not working, please, go to [page number 18](#). Most likely you need to change the LED light. Please don't forget, Safety First!

What should I do before I start to change the light in the lamp?

When you just have found out you need to change the LED light in the Light fitting, please, don't forget – Safety First! Before you start to changing your light, please, go to [page number 18](#) and [page 22](#), and read the instructions to make sure, you do it safely and correctly to avoid any injuries or damages. Electricity is a dangerous matter!

How can I change the light in the lamp?

After you have read the instructions, switched the power off and allowed the lamp to cool down, you can now change your light. Please, go to [page number 18](#) and read the manual Step by Step.

Which type of LED light do I need?

All downlights in the living room, kitchen, bedrooms and bathrooms are the LED lights type Orilight GU10. For more information about the Lights, please go to [page number 18](#).

1.3. Shower Unit

How can I operate my shower?

Instructions for operating your shower you can find here [page number 23](#).

Can I use detergents to clean my shower/bath?

The manufacturers strongly don't recommend to use any detergents for cleaning your bath, shower tray, basin and particularly to don't use any detergents for chromed shower house and basin mixer. This could cause damage of the chrome surfaces. For more information about cleaning your bathroom go to [page number 25](#).

How should I clean my Sanitary ware (shower tray, bath, basin, shower house shower mixer)?

Cleaning your bath, basin, shower tray, shower house and basin mixer is important for its long life. For the full instructions about safe cleaning your Sanitary ware, please go to [page number 25](#).

1.4. Home circulation Fan

What is MEV/MVHR and where is it located in my apartment?

In your apartment is MEV (Mechanical extract ventilation) or MVHR (Mechanical Ventilation and Heat Recovery). It's working automatically and nonstop and you don't have set anything. When the humidity of the internal air raises over 70%, MEV/MVHR is boosted itself.

MEV is basically removing used humid air out of your apartment.

MVHR is removing used humid air out of your apartment while it keeps the heat and use this heat to warm up the cold fresh external air blown inside.

In case you have MEV, it is located in your Utility cupboard in the ceiling.

In case you have MVHR, it is located in the Utility cupboard in your apartment on the wall, or in the Bathroom in the ceiling (you can see white plastic access in the ceiling).

For more information about MEV/MVHR, please go to [page number 27](#).

Is my MEV/MVHR air – conditioning/heating?

No, MEV and MVHR is not air-conditioning or heating. For more information, please go to [page number 27](#).

Why my MEV/MVHR doesn't make any noise?

MEV/MVHR is working nonstop 24hours 7days per week. Manufacturers are trying to design the system which produces as less noise as it is possible. MEV/MVHR is not supposed to do almost any noise.

Do I have to clean/change the filter of MEV/MVHR?

Manufacturers recommend to clean the filter every 6 month. For cleaning the filter, you can use a Hoover. For more information about Filter and its cleaning, please go to [page number 30](#).

1.5. Energy Monitor Device

What is Energy Monitor Device and where is it located?

Basically, Energy Monitor Device is monitoring energy consumption – Electricity and Energy Consumption produced by HIU for Heating and its costs. The device is set up for you and it is located on the wall in the living room next to the Thermostat. For more information, please go to [page number 31](#).

What does the Energy Monitor Device show to me?

You can track your costs and energy consumptions Daily, Weekly, Monthly, Quarterly and Yearly. Prices of energies are set up in the device, you don't need to set up anything. For more information, please go to [page number 31](#).

How can I see the costs of energies in my apartment?

You can click on "Home button" in the left lower corner and then choose whether you want to check your Electricity consumption or Energy Heating consumption. Energy Monitor Display offers you to see costs and consumption daily, weekly, monthly, quarterly and yearly. For more information, please go to [page number 31](#).

1.6. Door Entry Phone

What is the Door entry phone and where is it located?

The Door Entry Phone is a device which allows you to see your visitors by the main entrance of the Plot and open the main door for them. Your Door Entry Phone has camera function, Private mode and Door Open Button.

This device is located in the Hall in your apartment.

For more information, please go to [page number 37](#).

What should I do when the phone is ringing?

When called, the handset will give a distinctive call tone. Lift the hand – piece to speak with the caller. The video monitor will display for the length of the call (if the call is not answered, the system will reset to allow other visitors to make a call). To let the caller, gain an access, press the "Door Open" button. When the call is completed, replace the hand – piece to reset the system.

Can I set my own privacy mode?

If you don't wish to be disturbed, press the "Privacy" button. The "Privacy" button will illuminate and the call is muted when in the privacy mode. Press the "Privacy" button again to cancel the Privacy mode. There is a built-in timer that automatically cancels the Privacy mode.

1.7. Towel Rail Timeguard

What is the Towel Rail Timeguard and where is it located?

Towel Rail Timeguard is a device, which operates and controls the temperature of Towel Rails in your bathrooms. It is located in the Utility Cupboard. For more information, please go to [page number 38](#).

How can I set the Time and Date?

For Date and Times settings go to [page number 39 and 41](#) and please, read the instructions.

How can I set up my own weekly program?

You have up to 4 ON and OFF programmes available (5 day plus 2 or 7 day programmes) giving up to 28 ON and OFF programmes per week. Display offers you 1 or 2-hour boost facility and automatic Summer/Winter time changeover. For more information, how to set up your own program, please go to [page number 42](#), how to programming across midnight on [page number 44](#) and about modifying your program on [page number 44](#).

Can I set the program for each Towel Rail separately?

Unfortunately, not. You can set the same cycle for all Towel Rails.

Do I have to change the batteries?

The unit has an in-built non-replaceable, rechargeable battery, which will keep the programmed times during power restored, and 4 hours have elapsed (to give a working battery charge). Read more about batteries on [page number 39](#).

How can I boost my towel rail?

One press of the Boost button will provide a 1-hour boost, after which output will turn off. Two presses will give 2 hours' boost. A third press of the boost button will cancel any boost period.

2. Operate your Heating

2.1. Room Heating Controller - Introduction

The Altecnic 501 digital programmable room controllers have 7day function which allows operating times and temperatures to be set throughout the week.

The controller is easy to program. 3 per-set programs are already set in the controller's permanent memory (2 winter, 1 summer).

You can find information over the following pages about how to operate the Digital Programmable room controller.

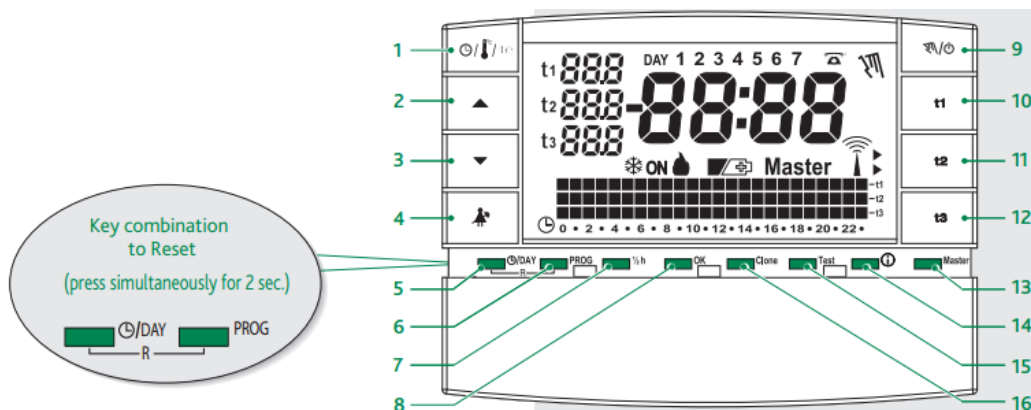

Figure 1

1. Select SET temperature: Comfort **t1**, Working **t2**, Economy **t3**
2. Increase temperature ▲
3. Decrease temperature ▼
4. Suspend program during room cleaning
5. Changes the current hour – minutes – day and displays the time and temperature
6. Select – display programs P 01 ÷ P 06
7. Half – hour program (1/2h)
8. Operation confirm button
9. Select manual mode and deactivate chronothermostat (OFF)
10. Set temperature **t1** Comfort
11. Set temperature **t2** Working (pre-comfort) and activates/disables the intelligent function
12. Set temperature **t3** Economy (energy saving)
13. Set temperature **t** ❄ Antifreeze
14. Time or temperature display
15. Winter 🔥 (heating) or summer ❄ (cooling) operation
16. View total hours operation

2.2. How to set your time and date

1. Use the ▲▼ keys to set the current time and press **OK** to confirm (Figure 2)

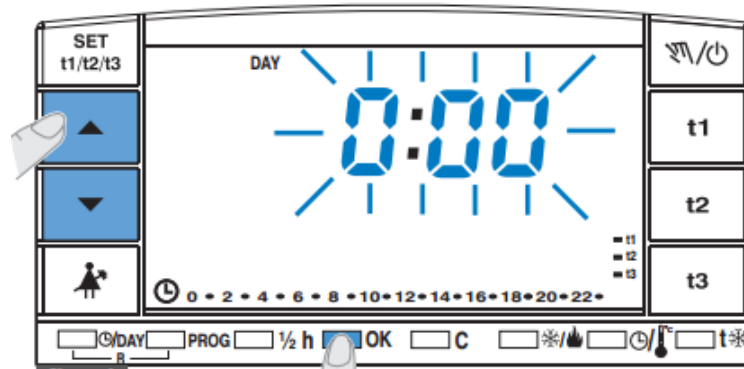

Figure 2

2. After having set the time, the first day of the week (1: Monday) will blink on the display. Select the current day by using ▲▼ keys and press **OK** to confirm. **P 01** will blink in the display. (Figure 3)



Figure 3

2.3. How to set your program

The chronothermostat in your apartment has **4 fixed programs** (from P01 to P04).

1. Press **PROG** repeatedly until the display shows particular program, then press **OK**. (Figure 4)

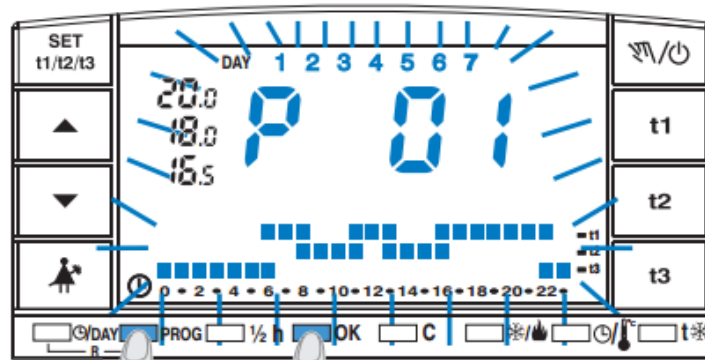

Figure 4

On the display, will appear:

- number of the current day
- the room temperature
- the 24-hour temperature scale as set in the current blinking hour digit

The chronothermostat is running from now onward in the Program chose by you.

Note: If you are NOT happy with any of these programs and it does not appear to be suitable for you, press **PROG** repeatedly until program **P 05** appears and press **OK**. This program can be freely set up for every hour of the day of the week.

2. Confirm selection of the program **P 05** (Figure 5)

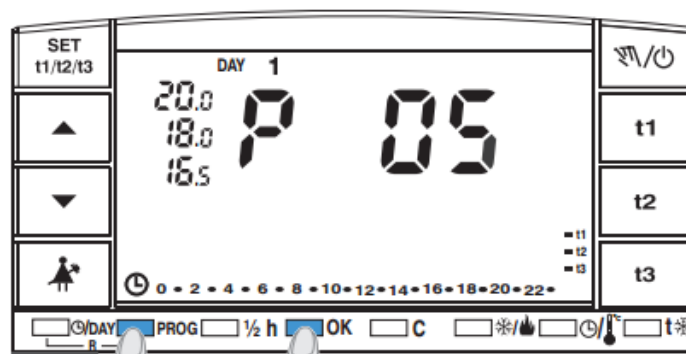



Figure 5

- The display will show **0:00** with the day indicator **1 (Monday)** – all blinking. To select the temperatures for the time currently blinking, press relative button (**t1**, **t2**, **t3**, **t** ) (Figure 6)

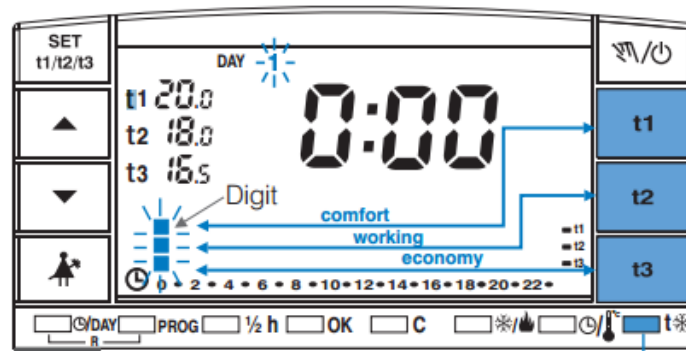
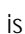

Figure 6

- Press **Prog** to exit from P05 without saving

SETTING THE TEMPERATURE FOR MONDAY (1):

- For each hour of the day, confirm the desired temperature (Comfort, Working, Economy, Antifreeze) by pressing (**t1**, **t2**, **t3**, **t** ) until the 24 – hour cycle for Monday is complete. (Figure 7)

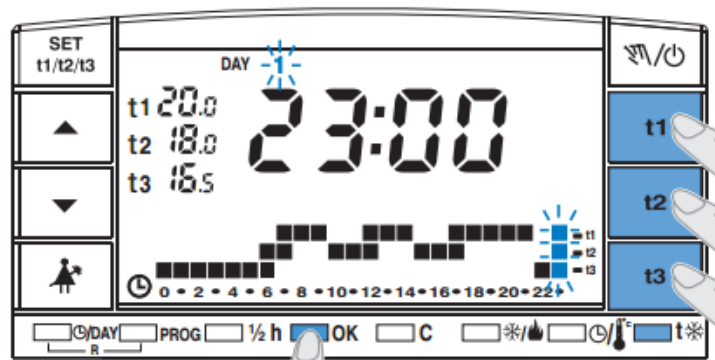

Figure 7

Note: the time is confirmed every time the key is pressed and the hour moves forward by one hour

- When **OK** is pressed to confirm, the program set for Monday is saved in the memory, the dash will blink under **Tuesday (2)** and the digits relative to the time **0:00** will blink over the temperatures scale for the previous day (Figure 8)

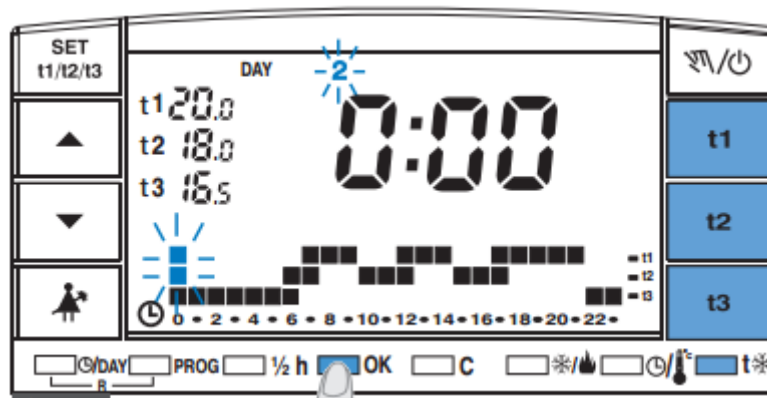

Figure 8

SETTING THE TEMPERATURE FOR TUESDAY (2):

- You have 2 options:

Option A - If you want to use THE SAME temperature scale as for **Monday (1)** – press **OK** and the same scale will be added for Tuesday; the dash will blink under **Wednesday (3)** and the 0:00 will blink again

Option B - If you want the DIFFERENT temperature scale for **Tuesday (2)** than for **Monday (1)**, proceed the temperature scale by pressing **t1**, **t2**, **t3** and **t*** - come back to point SETTING THE TEMPERATURE FOR MONDAY (1), and set the temperature for next day same as Monday (1) is described

- Having set the temperatures for Tuesday, press OK to confirm.

Note: You **MUST** complete the daily profile for each day of the week, otherwise the program setting cannot be saved.

Once the temperature scale is entered for **Sunday (7)**, press **OK** (Figure 9) to save and return to the **Monday (1)** setting, then press OK again for 4 seconds (Figure 10) = this operation saves the complete weekly program.

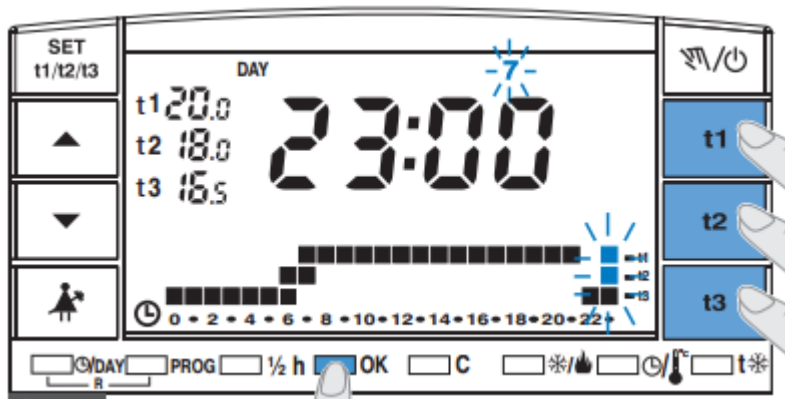

Figure 9

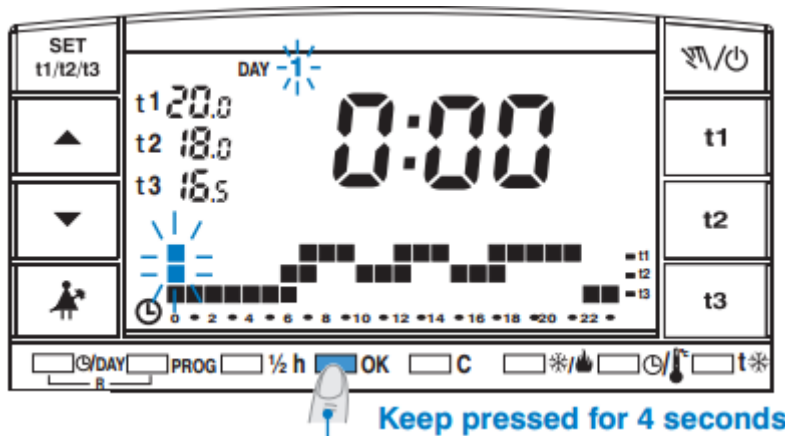

Figure 10

Note: The display will show:

- the number of the current day
- The room temperature
- The temperature scale over 24 hours

THE CHRONOGRAPH NOW IS IN OPERATION.

2.4. Programming summer - winter



The chronothermostat is factory-set for “**Winter**” operation, displayed as: 🔥 (heating).

Temperature set points:

t1 – Comfort = 20,0 °C

t2 – Working = 18,0 °C

t3 - Economy = 16,5 °C

t❄️ - Antifreeze = 5 °C



If the controlled appliance is an air conditioner: press the ❄️/🔥 button for “**Summer**” (heating) operation, displayed as ❄️.

Temperature set points:

t1 – Comfort = 20,0 °C

t2 – Working = 22,0 °C

t3 - Economy = 23,5 °C.

2.5. How to change Comfort, Working and Economy modes

If the factory set temperatures:

t1 = 20,0 °C, t2 = 18,0 °C, t3 = 16,5 °C (winter)

t1 = 20,0 °C, t2 = 22,0 °C, t3 = 23,5 °C (summer)

doesn't appear to be suitable for you, they can be changed per preference from +5 °C to +39 °C, by pressing relative buttons. (Figure 12)

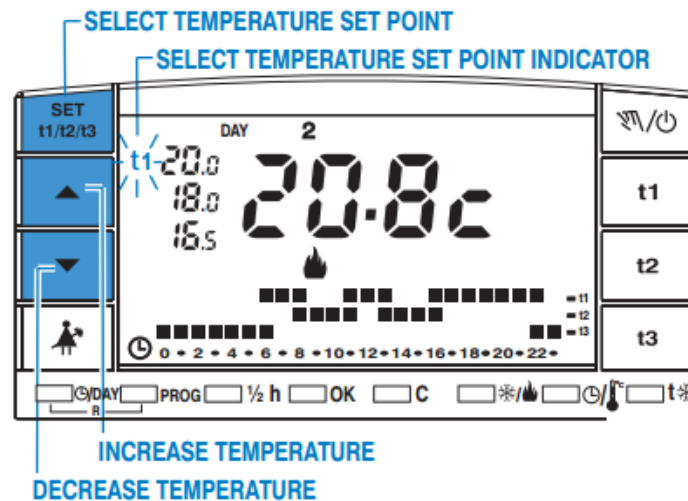



Figure 11

1. Use the ^{SET} t1/t2/t3 (press repeatedly) to select the temperature set point that needs changing, indicated by the t1 O t2 O t3 blinking symbol.
2. Set the current set point by pressing buttons: ▲ ▼ momentarily. At each touch the values changes by 0,1 °C
3. The new temperatures selected in this way will be the new set points (for all programs). Approximately 8 seconds after the last key press, the screen will revert to displaying the thermostat's regular functions: the temperature SET indicator for the current time (t1 or t2 or t3) will be displayed.

2.6. How to temporarily change the temperature in your apartment

Briefly press : the  symbol will blink on the display and the current temperature level will be applied to the remaining hours of the day (Figure 12). Set the desired temperature for when in manual mode by pressing t1, t2, t3 or t*; set the desired temperature by pressing the ▲▼ keys.

Note: The temporary manual mode will automatically terminate at midnight of the current day.

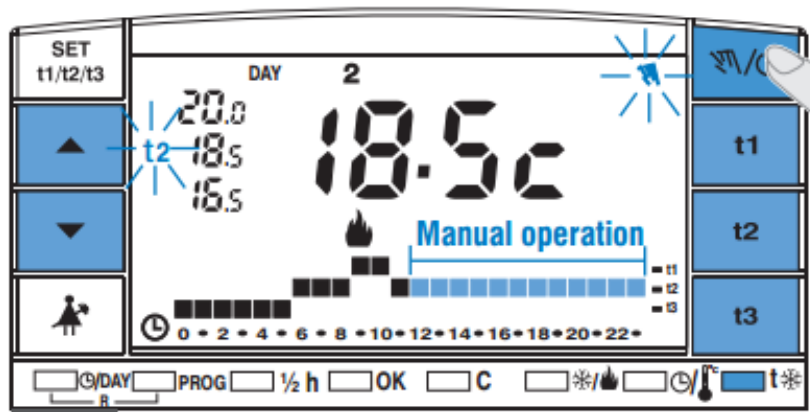

Figure 12

3. Apartments Lamps and Lights

3.1. Product Description

The lighting installed in your apartment is an Orlight illumination light fitting. The fitting consists of a Die-Cast Aluminium fixture with anti-glare baffle including replaceable GU10 LED Engine. The units housing comprises of a simple magnetic lamp change mechanism for ease of maintenance. There is an Orlight black light effect for visual comfort. The unit features the latest in Sharp generation – 5W chipset ~ 3000K.

3.2. Light fixture components

Type: Orlight Product



Figure 13

Orlight Lamp: GU10 240V 50W max

3.3. How to change your lamp bulb

NOTE: SAFETY FIRST!

- Please, use the correct PPE (Personal protective equipment):
 - ✓ Safety glasses
 - ✓ Appropriate hot work gloves
- Please, use a safe raised working platform and do not stand, kneel or ever use the HIU cupboards shelf as a working platform

Step 1: Turn the power off

Before you start to process any changes, please, make sure the power to the lights within your apartment is switched off. The safest way to ensure about it is to isolate the power by turning it off at the source. Turn off the isolator switch prior to commencing work, by flicking

the MCB, on the breaker/fuse box, within the HIU cupboard to its off position (Figure 14 and 15).

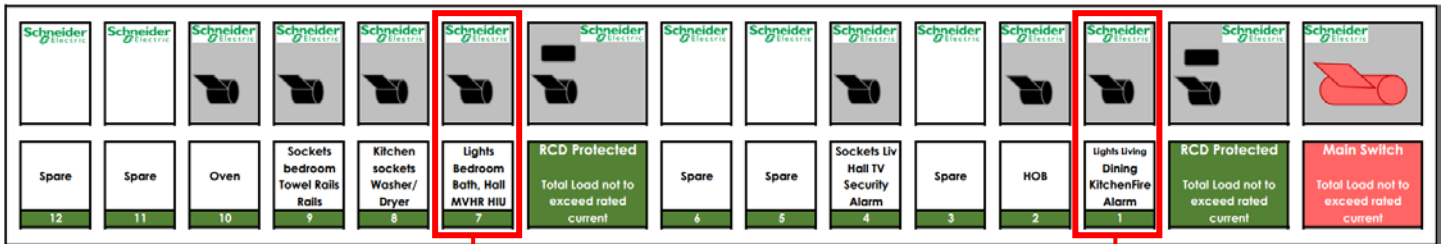

Figure 14

Switch for lights in Bedroom, Bath and Hall

Switch for lights in Living room, Dining room and Kitchen

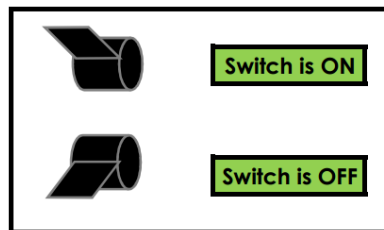

Figure 15

Step 2: Allow the lamp to cool down

Allow enough time for the lamp to cool down if necessary, before attempting to touch and separate the housing or to change the bulb.

Step 3: Separate the Light Housings

- Using your index finger and thumb, gently separate the magnetic inner fitting (ceiling light housing) from the downlight (lamp housing) by pulling it in a downward motion. This will release the magnetic mechanism within the housing and separate the housings of the light fitting (ceiling housing from the lamp housing).
- Continue this motion of moving the two housings away from each other and allow cable to extend through the lights ceiling housing in your apartment.
- Please follow the steps below.



Step "A"



Step "B"



Step "C"



Step "D"

Step 4: Remove the Lamp

- Holding the lamp housing in one hand and the spring (figure "A" below), which holds the lamp holder in place, in your other hand, gently remove the spring from the lamp holder. Repeat this process on the second lamp holder spring (figure "B").
- Separate the lamp and lamp holder from downlight (lamp housing).
- Hold lamp holder with a firm grip and simultaneously clasp the lamp in a light but firm grip, turn the bulb in an anticlockwise quarter turn, to release the lamp from the lamp holder fitting.



Step "A"



Step "B"



Step "C"



Step "D"

Step 5: Replace the Lamp

- With a new lamp in your hand prepared in advance, insert the replacement lamp into the lamp holder. Twist the bulb in a clockwise quarter turn.
- Replace the lamp and lamp holder into the downlight (lamp housing).
- Holding the lamp housing in one hand the spring, which holds the lamp holder in place, in your other hand, gently replace the spring into the lamp holder fitting. Repeat this process on the second lamp holder spring.
- Now you can begin to move the inner fitting (lamp housing) into the downlight fitting (ceiling light housing). As you move these two fixtures together, guide the electrical wire into the ceiling crevice. Once the fixtures touch each other, it should stick together in a fixed position magnetically.

Step 6: Turn the power on

- Now that the new lamp has been fitted and you feel as though you have safely carried out the replacement procedure, switch the MCB up to Turn the Power on to the Lights within your apartment.

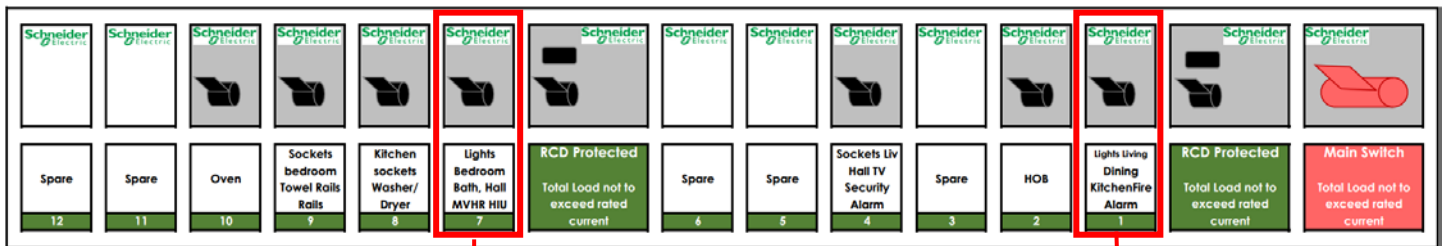

Figure 16

Switch for lights in Bedroom, Bath and Hall

Switch for lights in Living room, Dining room and Kitchen

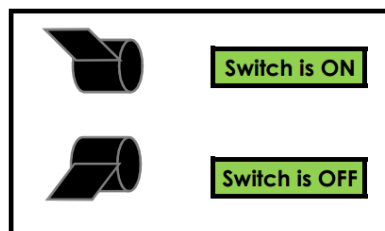

Figure 17

Step 7: Disposal

- It is necessary to dispose of the old lamp. This needs to be done in a safe manner, as the old bulbs glass may be fragile and very sharp. One approach to this is to wrap the old lamp in the packaging of the newly fitted lamp and use special collection containers intended for glass.

3.4. Lamp safety

Safety critical when working with faults related to electrical or wiring issues. Remember to always check the following:

1. The wattage on the old used bulb and replace it with a new lamp of the same wattage.
2. Keep your fingers away from live electrical wires and do not put your fingers in the exposed light socket.
3. In the interest of health and safety, dispose of the light lamp well out of the reach of the children.

4. Shower Unit

Type: Hangsrohe Croma 220

4.1. Operation

Opening and closing

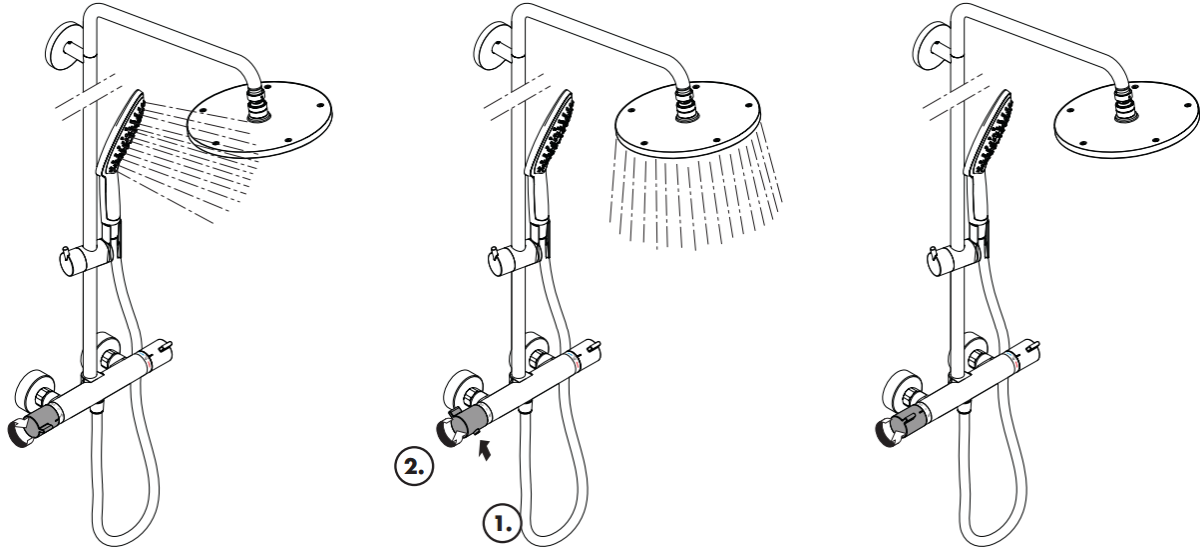

Figure 18

Temperature settings

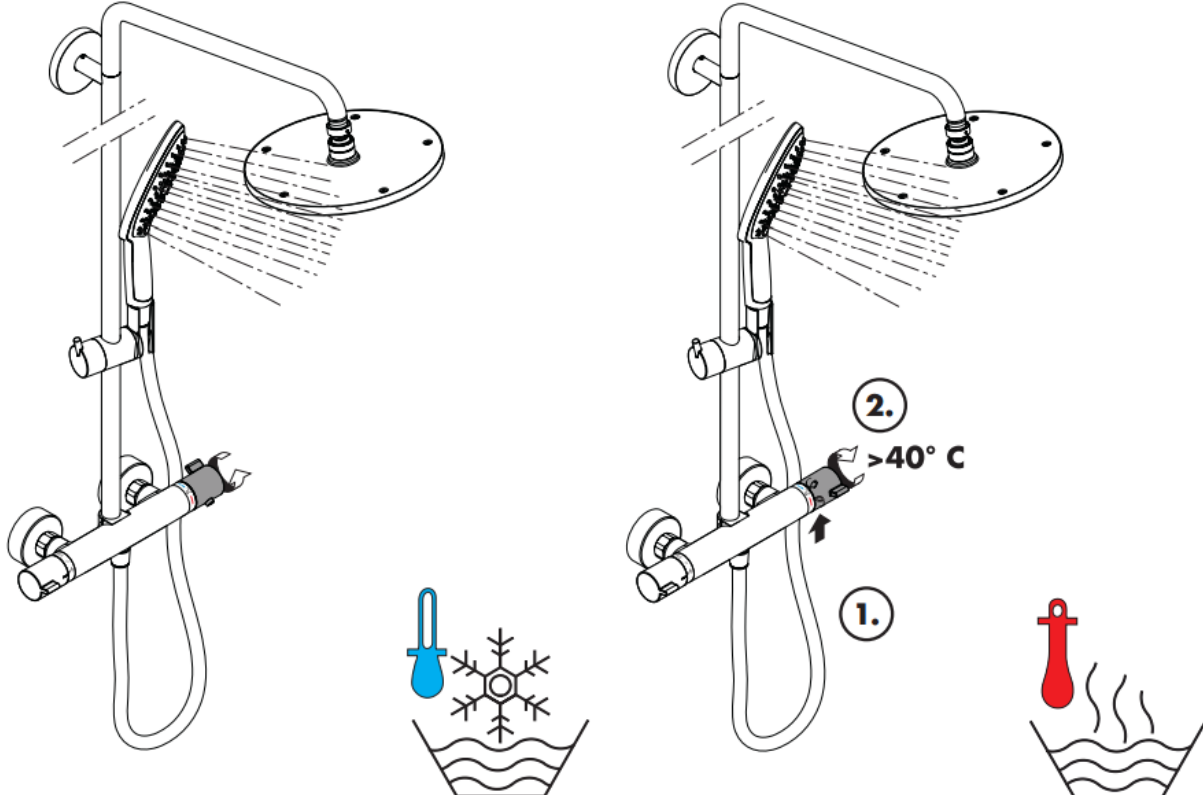

Figure 19

Alternatives

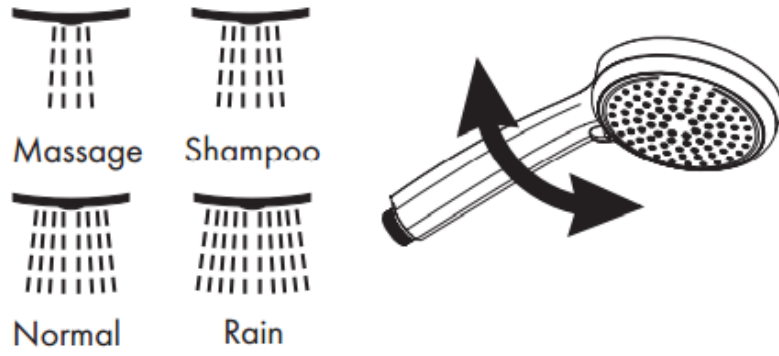

Figure 20

Angle settings

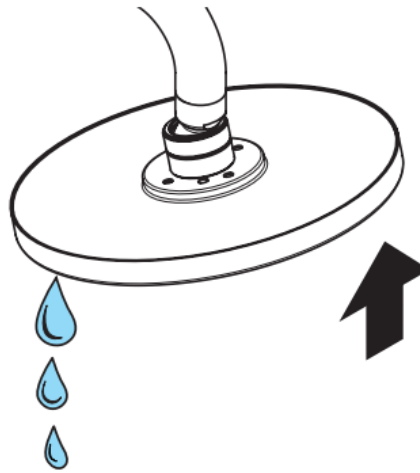

Figure 21

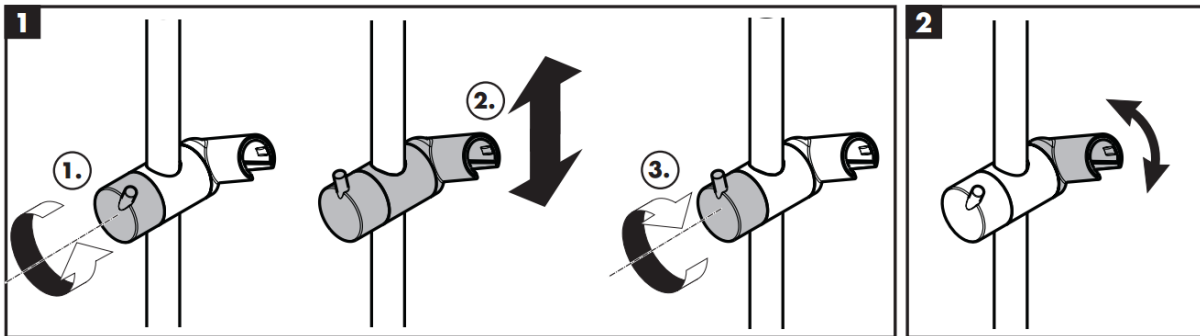

Figure 22

4.2. Cleaning Shower Head

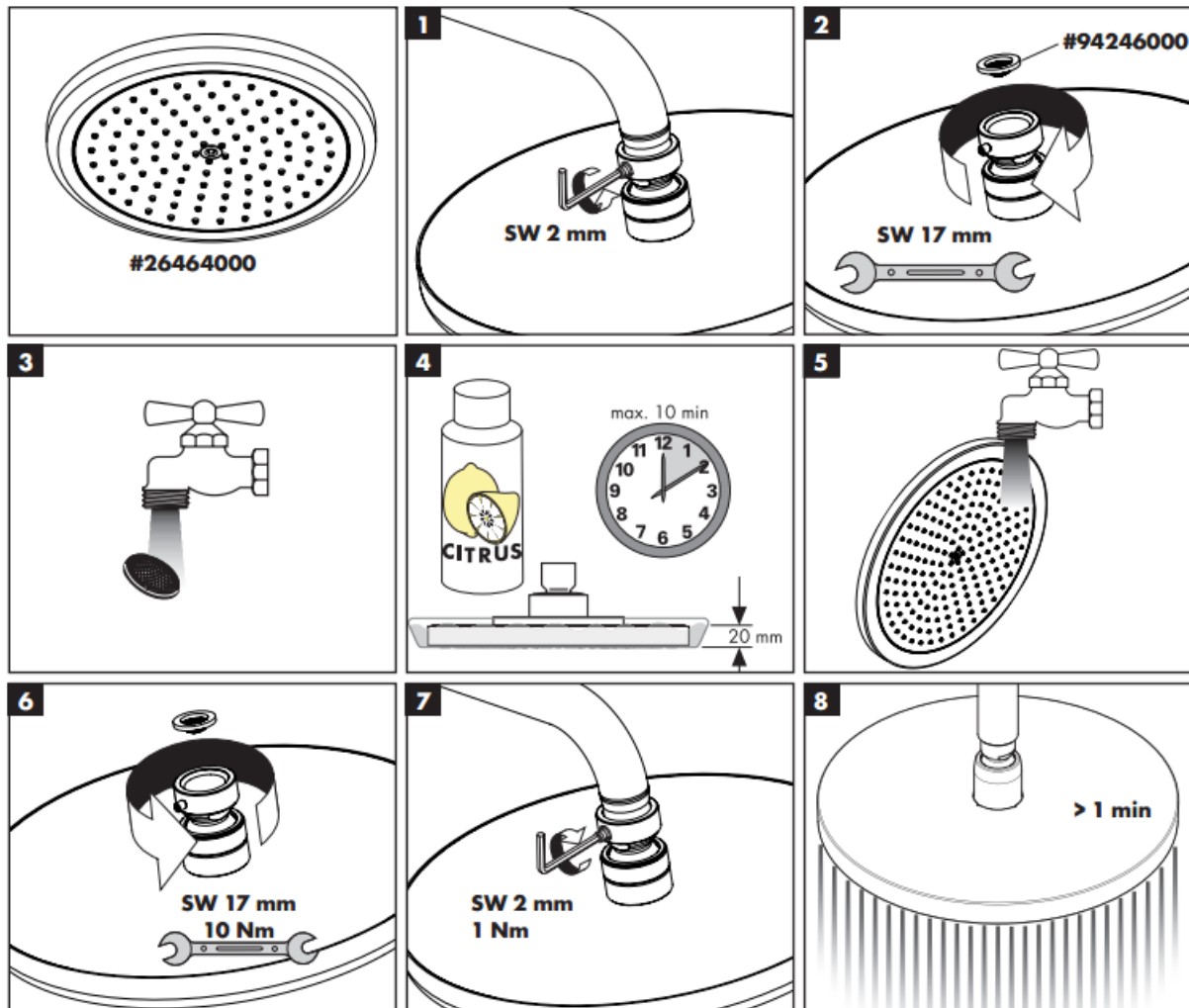

Figure 23

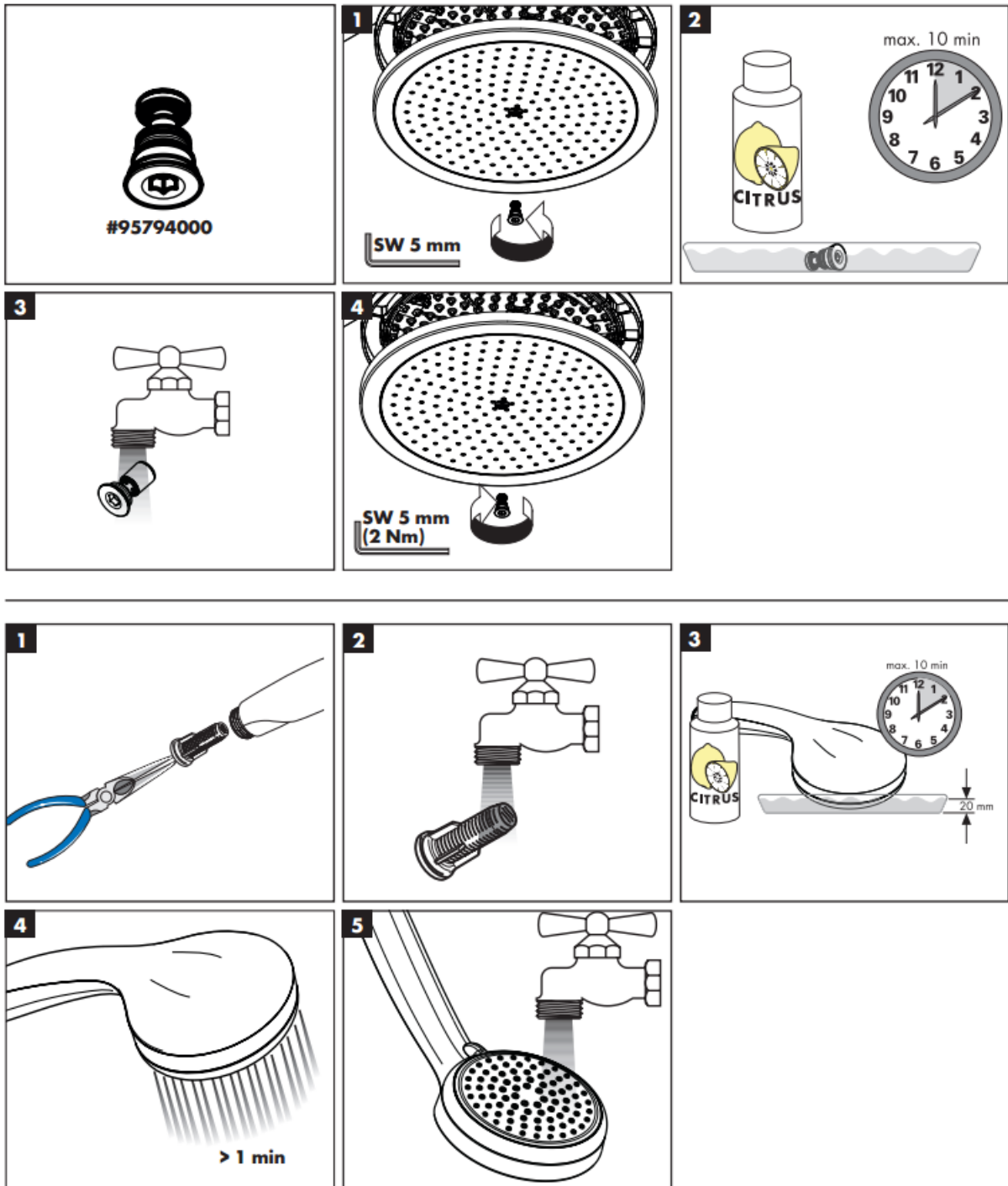

Figure 24

5.Home Circulation Fan

5.1. Description and Fan Types

Note: It is strongly recommended to read the FAQ for this chapter.

In your apartment is installed Vent – Axia MEV Fan or Vent – Axia MVHR Fan – it depends on type of your apartment (*Figure 25*).



Figure 25

MEV Fans (Mechanical Extract):

1. Vent – Axia Lo-Carbon Multivent Ventilation systems (MVDC – MSH); Boost operated by humidity sensor

MVHR Fans (Mechanical Ventilation with Heat Recovery):

1. Vent – Axia Sentinel Kinetic MVHR; whole house mechanical supply and extract ventilation unit c/w recover; Boost operated by integrated humidity sensor. For basic description, please read the FAQ.
2. Vent – Axia Lo-Carbo Sentinel Kinetic MVHR; whole house mechanical supply and extract ventilation unit c/w recover; Boost operated by integrated humidity sensor

Note: These systems are heat recovery ventilation systems, **NOT AIR-CONDITIONING SYSTEM.** It offers the highest level of comfort and control available.

Note: The most common concern with home owners is that heat ventilation devices create noise. With Advance, absolute optimisation of every element does everything possible to minimise generation and transmission of both motor and airflow noise.

5.1. MEV Fan (Mechanical Extract)

Type: Vent – Axia Lo-Carbon Multivent Ventilation systems (MVDC – MSH)

Location of MEV in your apartment: in the Utility Cupboard, in the ceiling

You don't need to setup anything. MEV Fan is working automatically.



Figure 26

5.2. How MEV Fan works

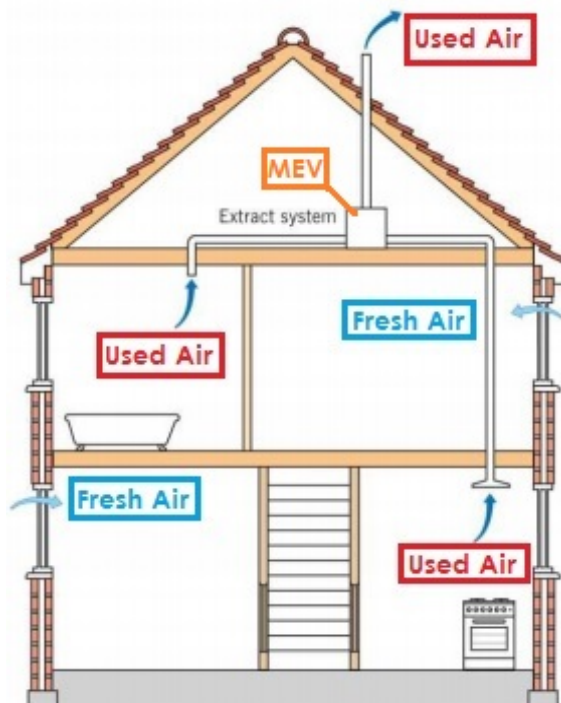

Figure 27

- ✓ MEV extracts continuously at a low rate based on guidelines laid out in Building Regulations Part F and incorporates a boost facility to extract pollutants at a higher rate as required
- ✓ Can be controlled either:
 - Manually via single or multiple switches including light switches
 - Automatically, typically via humidity or other sensors
- ✓ The MEV ventilation unit is normally sited remotely in a cupboard and ducted via rigid duct to outside air using the most economical route

5.3. MVHR Fan (Mechanical Ventilation with Heat Recovery)

Type: Vent – Axia Sentinel Kinetic MVHR

Location: in the Utility Cupboard, on the wall

You don't need to setup anything. MVHR Fan is working automatically.



Figure 28

5.4. MVHR Fan (Mechanical Ventilation with Heat Recovery)

Type: Vent – Axia Lo-Carbo Sentinel Kinetic MVHR

Location: in the Bathroom, in the ceiling

You don't need to setup anything. MVHR Fan is working automatically.



Figure 29

5.5. How MVHR works

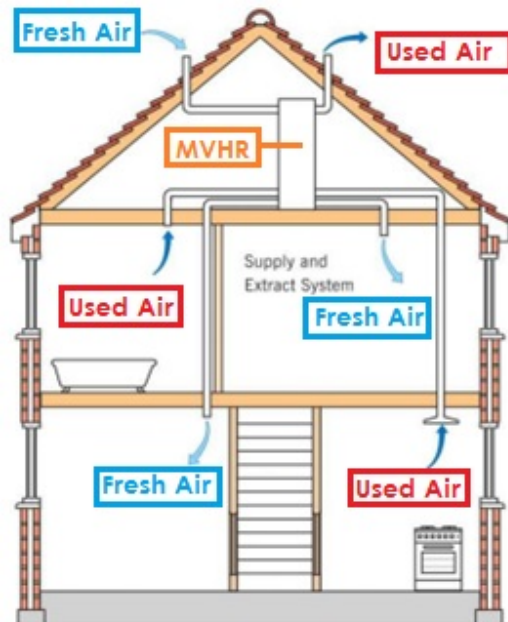



- ✓ MVHR supplies & extracts air continuously at a low rate with boost facility to extract pollutants and supply fresh outdoor air at a higher rate as required
- ✓ Can be controlled either;
 - Manually via single or multiple switches
 - Automatically, typically via humidity or other sensors These should be clearly marked and located in an accessible location in or near the wet rooms
- ✓ Replacement tempered air is introduced into bedrooms and living areas by the system, therefore background ventilators in windows are not required

Figure 30

5.6. Filter Maintenance

When the Unit displays "Check filters" – this is reminder to ensure that the filters are not so dirty that they are blocking the airflow or allowing dirt to pass through. The rate at which the filters become dirty will vary depending on the environment and the activity within the property.

1. Remove 2 filter cover plates and filters.
2. Clean gently by tapping or carefully using a vacuum cleaner if necessary
3. Replace the filter and cover plates
4. Reset the automatic message, press and hold the  and  buttons for 5 seconds

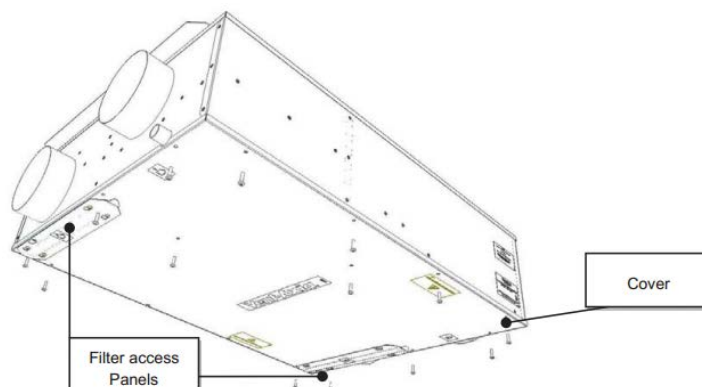

Figure 31

6. Energy Monitor Device

6.1. Insight

A cost-effective insight and monitoring system to track your energy use in the home. This device is for energy monitoring in your apartment. The systems are self-learning and profile your normal energy use, alerting you when you exceed them. It has a built-in web server and Wi-Fi access point enabling it to transmit energy data costs. Basically, Energy Monitor Device is monitoring energy consumption – Electricity and Energy Consumption produced by HIU for Heating.

6.2. Contents of Energy Monitor Device

Contents: 1x 5" tablet Display (Figure 32) – located on the wall in your living room

1x Netthings Controller (Figure 33) – located in the Utility Cupboard in your apartment



Figure 32



Figure 33

6.3. Powering Up & Setup Procedures

1. Power up the controller and wait for the lights to come on and for it to broadcast its own Wi-Fi signal. Power Up the display and wait until you see the SSID for your controller shown on the display. **Swipe down on display screen to refresh the Wi-Fi signals seen.**
2. To connect the display to the controller, use either of these 2 methods (Figure 34 or Figure 35)



Figure 34



Figure 35

3. Once connected you will see these screens (Figure 36)



Figure 36

4. To set up the system press the “NETTHINGS” logo on the “All Channels Off” screen. The set-up menu, as shown here, will then be displayed. (Figure 37 and Figure 38)

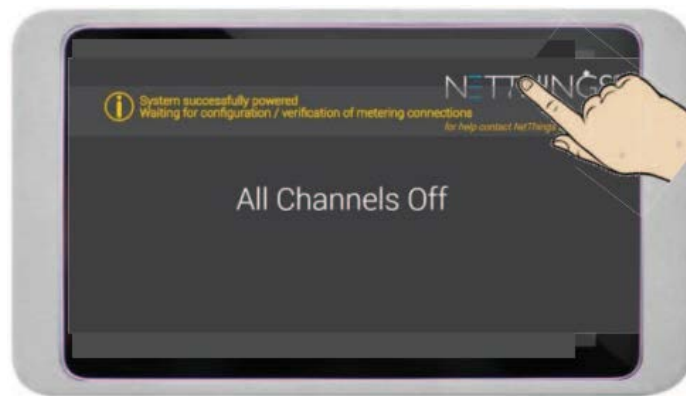

Figure 37

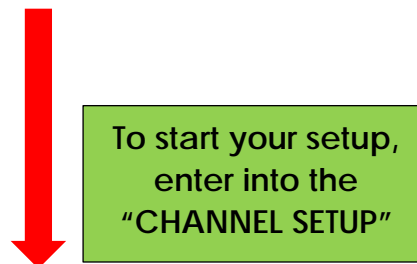

Figure 38

- Fill in the details as previously noted during the final connection stage of installation for the **NAME, TYPE & PULSE VALUE** for each of the connected channels. Repeat for all channels that are being used to monitor energy usage. Don't forget to turn "ON" the connected channels and save your settings. (Figure 39)



Figure 39

(Typical screen for the channel setup)

- At this stage your set up is complete and the energy manager will operate and record the energy data from the connected energy sources, verify system operation by consuming energy and checking that the channels are recording correctly on the home display.
- Once all channels have been verified as fully operational then the Configuration/Verification banner should be switched off. To do this, enter the **OVERVIEW** section of the setup menu. (Figure 40 and Figure 41)



Figure 40

This page gives you an overview of all your settings and has an "Activate Configuration" at the bottom of the screen



Figure 41

When you are happy that the setup is correct and fully operational press here.

8. To turn off the **Configuration/Verification** banner press the on/off button and then save the setting.
9. Exit back out of the setup menu and do a final check that all used channels are showing for the end user. (Figure 42)

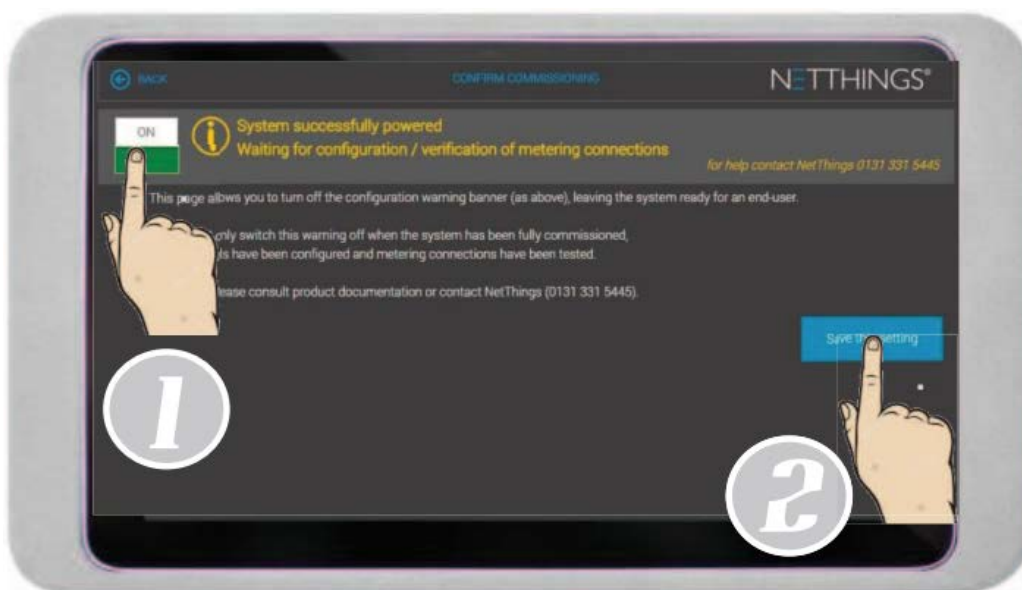

Figure 42

6.4. Help Section

Incorrect or no activity shown on the Home Display

Please check the following items if you cannot verify any energy usage

- Ensure your home display is connected to your Energy Manager Controller – Un-pair the Display and reconnect to the correct **SSID**
- If the Home Display or Energy Managers stops working – please restart the system and home display
- Incorrectly connecting pulse inputs to CT connections and vice versa

Any other problems

Please check the following if you have problems

- Energy Manager doesn't power up – check that the core is properly seated on the base
- How do I change tariff settings? - this is normally left to the homeowner as the default tariff settings will allow the device to operate sufficiently
- The time is incorrect – you will need to log into the Wi-Fi signal coming from your Energy Manager via a PC or phone and enter the web address of **172.16.0.254/set-time** on the devices web browser. Follow the onscreen instructions

7. Door Entry Phone

Type: ENTROTEC EV+ Video Handset with Concierge Call Back Button

7.1. User guide

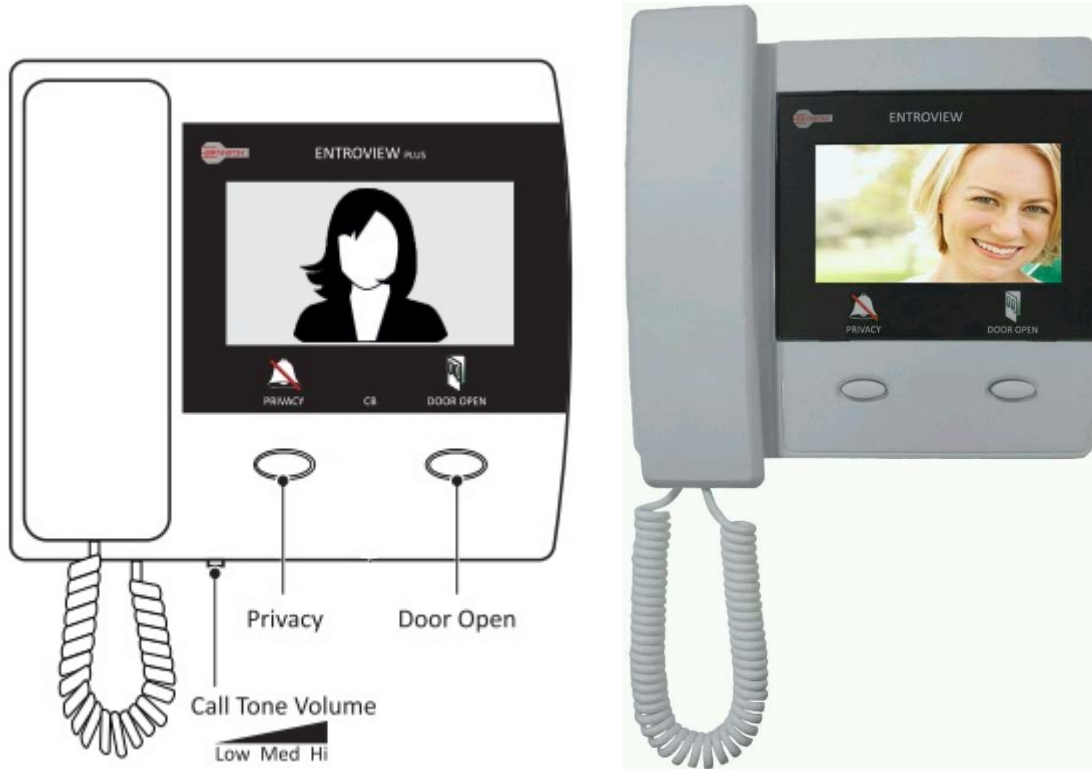

Figure 43

1. When called, the handset will give a distinctive call tone. Lift the hand – piece to speak with the caller. The video monitor will display for the length of the call (if the call is not answered, the system will reset to allow other visitors to make a call).
2. To let the caller, gain an access, press the **“Door Open”** button
3. When the call is completed, replace the hand – piece to reset the system
4. If you don't wish to be disturbed, press the **“Privacy”** button. The **“Privacy”** button will illuminate and the call is muted when in the privacy mode. Press the **“Privacy”** button again to cancel the Privacy mode. There is a build in timer that automatically cancels the Privacy mode.
5. The call tone volume can be adjusted using the 3 positions slide switch on the bottom of the handset.

8. Towel Rail Timeguard

Type: Timeguard 7 Day Fused Spur Timeswitch FST77

8.1. Description

Towel Rail Timeguard is for **feeding and controlling the Towel Rail** in the apartments. It has easy viewing display, optional 1 or 2-hour boost facility and automatic Summer/Winter time changeover. You have up to 4 ON and OFF programmes available (5 day plus 2 or 7 day programmes) giving up to 28 ON and OFF programmes per week.

Location: Utility Cupboard



Figure 44

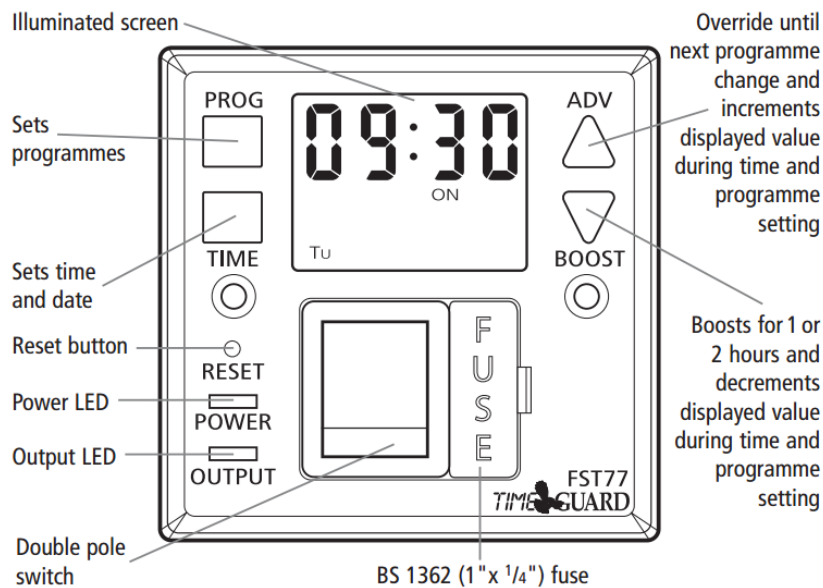

Figure 45

8.2. Battery

The unit has an in built non-replaceable, rechargeable battery, which will keep the programmed times during power is restored, and 4 hours have elapsed (to give a working battery charge), Reset must be pressed, and times/programmes re – entered.

Before programming for the first time, connect the unit to the mains for at least 15 minutes' prior pressing the Reset button and programming the unit. If the display is not visible or very faint, charge for 4 hours prior to pressing Reset and programming.

8.3. Setting the clock

1. Press and hold down the Time button for 3 seconds. The word hold will show on the screen.
2. After 3 seconds, the screen will show a year.



Figure 46

3. Use the Adv or Boost buttons to change the year to the correct year.
4. Press Time to set the year, and then the month will show.



Figure 47

5. Use the Adv or boost button to adjust the day to the correct day.
6. Press Time to set the day, and then the time will show, hours first.



Figure 48

7. Use the Adv or boost button to adjust the hour to the correct hour.
8. Press Time to set the hour, and then the time will show the minutes. The hour is a 24-hour clock.
9. Use the Adv or boost button to adjust the minutes to the correct minutes.
10. Press Time to exit the Time/date entry mode. The display should now show the correct time/day of the week.



Figure 49

Note: during time/date setting, when Adv or Boost buttons are held down, the setting under adjustment will advance or decrease more rapidly.

8.4. Modifying the Time & Date of Day

1. Normally the only change required will be to the time of day minutes, in which case press and hold Time for 3 seconds, during which hold will show on the display.
2. After 3 seconds the display will show year:



Figure 50

3. Press Time repeatedly until the minutes are shown. Use Adv or Boost to change the minutes to the correct value. Press Time to return to operating mode.
4. Other changes can be made the same way, but the Time button must be pressed to return to operating mode after any changes, there is no automatic exit from Time/date entry mode.

8.5. Programming On/Off times

1. The FST77 has 4 independent On/Off periods available for programming each day. There is a choice of programming options, including 7 days the same (24 hours), 5+2 days (where the weekdays are the same, and the two weekend days are the same), and 7 individual days.
2. Press and hold the Prog button for 3 seconds. Whilst holding, the word Hold should show on the display.
3. After 3 seconds, the mode screen will show.

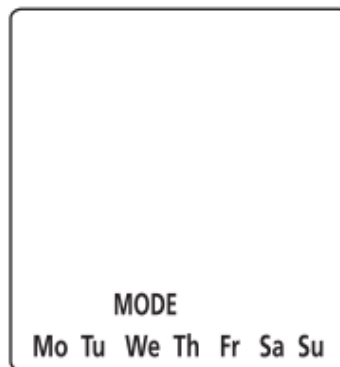

Figure 51

4. Use Adv or Boost to change the day grouping mode. This will step through the following options:
 - ✓ 24hr – Mo Tu We Th Fr Sa Su
 - ✓ 5day - Mo Tu We Th Fr followed automatically in programming by 2 day – Sa Su
 - ✓ Individual day – Mo followed automatically in programming by each of the other days
5. Once the desired day grouping is selected, press Prog to move onto programming On/Off times. The display will show Prog 1, with dashes for the hours and minutes.

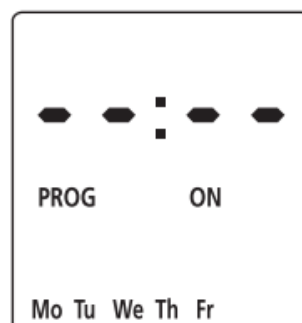

Figure 52

6. Example shown is for 5+2 programme.
7. Use Adv or Boost to set the hour for the first on period. Press Prog to change to setting the minutes.
8. Press Prog to change to programme 1 off time.

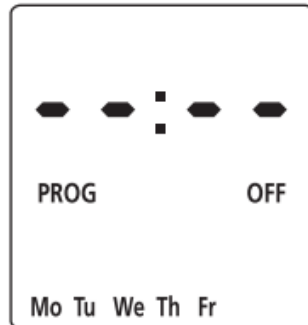

Figure 53

9. Press Prog to scroll through programme 2 on, programme 2 off, programme 3 on, programme 3 off, programme 4 on and programme 4 off, adding in times as required.
10. If times are not required, just leave the dashes in place, and scroll past that programme.
11. After programme 4 has been entered, the day will index to the next day to be programmed, or in the case of 5+2 it will change to Sa Su.
12. Programme the On/Off times as before.
13. After the last off time for programme 4 has been set, press Prog to exit programme mode.
14. At any stage in programming, if the Prog button is pressed and held for 3 seconds, the times will return to operating mode.
15. The display will now show:



Figure 54

16. Where the day and time are correct, but the On/Off indicator may not reflect the current programme accurately, in which case press the Adv button to correct the indicator.
17. In the same way, as for individual programmes, days or groups of days can be omitted either by leaving dashes in all the locations for On/Off times for that day or group of days. Alternatively, leaving the programme entry mode before filling in all the On/Off times will leave the remaining times blank.
18. The only way to re – enter a blank time is to reset the unit.

8.6. Programming Across Midnight

1. Enter the programme on time as above
2. Enter the programme off time as 00:00
3. Enter the first programme on time for the next day as 00:00
4. Enter the required programme off time

Note: for 24 hours, the on period for programme 1 must start 00:00.

8.7. Modifying or Adding Programmes

1. Press Prog and hold for 3 seconds. Whilst holding, the word hold will appear on the display.
2. After 3 seconds the display will show the programming mode screen.
3. This will be in the mode in which it was last programmed. For instance, if it was programmed 5+2, then it will show Mo Tu We Th Fr. Either accept this, press Prog, and review the times programmed for this mode by pressing Prog, or press Adv or Boost to change the mode, and then press Prog to review the times. In this case, either to Sa Su, or to 7 day or to individual days.

Note: If the unit was programmed as a 5+2 then changing the mode to any other mode than Sa Su may blank any previous programming.

The same applies for changing from any other mode, changing from the mode it was last programmed in may blank the previous programme.

8.8. Boost

1. One press of the Boost button will provide a 1-hour boost, after which output will turn off.
2. Two presses will give 2 hours' boost.
3. A third press of the boost button will cancel any boost period.